

Broadband Battery Back-Up Unit CPL28U12

Safety Guide-Important Save this Information

This Safety Guide contains important instructions that should be followed during installation and maintenance of equipment and batteries. It is intended for customers who setup, install, relocate, or maintain the equipment.

Changes and modifications to this unit not expressly approved could void the warranty.
Failure to observe these warnings may result in serious injury, death or damage to the equipment.

- Electrical Warnings** Servicing this equipment may require working with protective covers removed. Use extreme caution during these procedures.
 Check that the power cord(s), plug(s), and sockets are in good condition.
- Battery Warnings** To avoid personal injury due to energy hazard, remove wrist watches and jewelry such as rings when replacing the batteries. Use tools with insulated handles.
 Danger of explosion if battery is incorrectly connected or replaced.
 Replace batteries with the same type of batteries as originally installed in the equipment.
- This unit is intended for indoor use only.**

Environmental Specifications

Operating Temperature	-4° to 131° F (-20° to 55° C)		Install the Battery Back-Up Unit in a protected area that is free of excessive dust and has adequate airflow. Do not operate the unit where the temperature and humidity are outside the specified limits.
Operating Humidity	95% noncondensing within enclosure		
Max Operating Elevation	10,000 ft (3,000 m)		
Max Storage Elevation	50,000 ft (15,000 m)		

Electrical Specifications

Input	Output	Max Signal Voltage	Max Signal Current	Battery Type
40–60 VDC (48 VDC nominal) 1 A	10–20 VDC 28 W (12 VDC nominal)	30 V	5 mA	12 V 7.2 AHr Spill-Proof, Maintenance-Free, Sealed Lead Acid

Check the package contents

- Battery Back-Up Unit
- Two Pin Output Connector - installed
- Battery Connector Cable - installed
- Product Documentation
- Seven Pin Insulation Displacement Connector (IDC) - installed

Installation

Mounting the Enclosure

Use a mounting technique that is appropriate for the weight of this unit and the mounting surface material. This unit weighs 7.5 lbs (3 kg) with the battery installed.

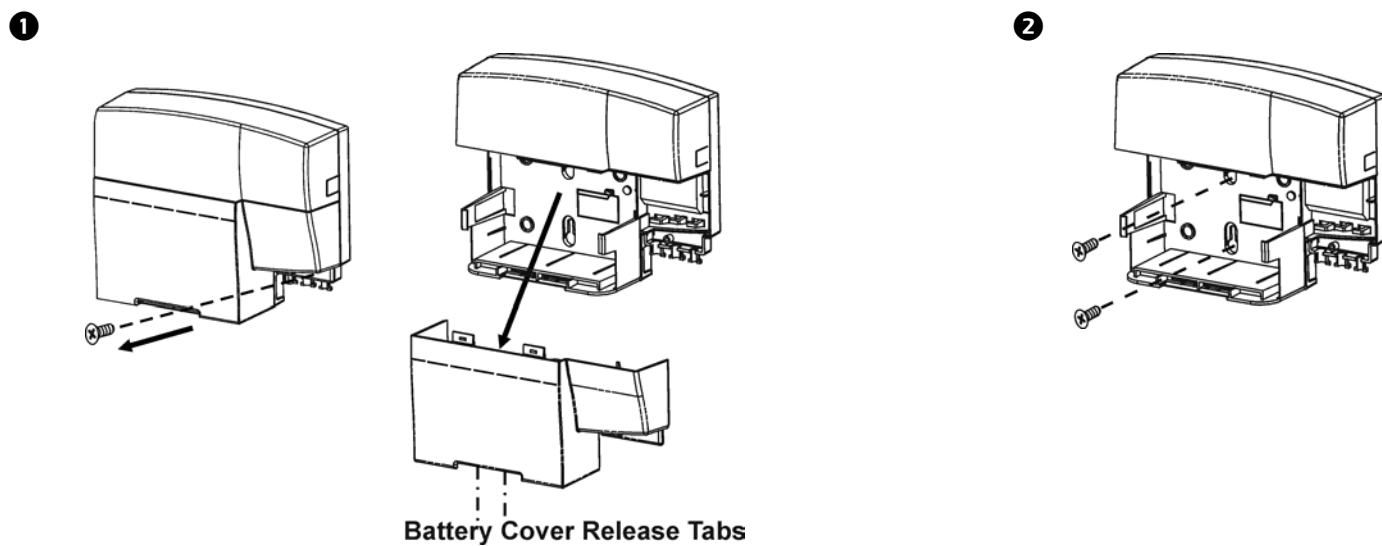

Battery Installation

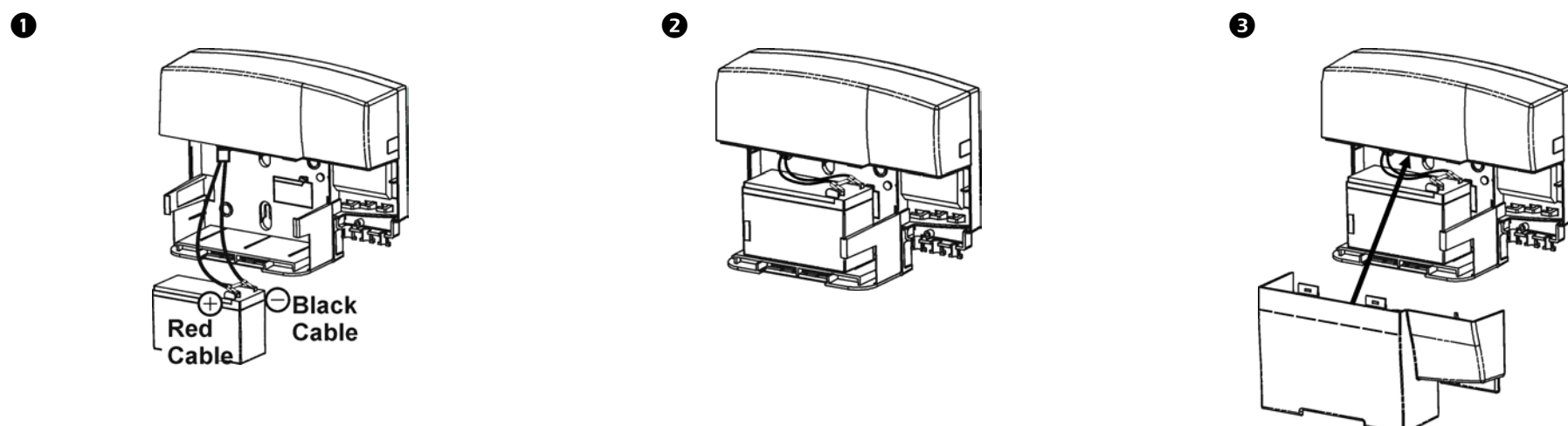

Connect Communications, Input and Output Cables

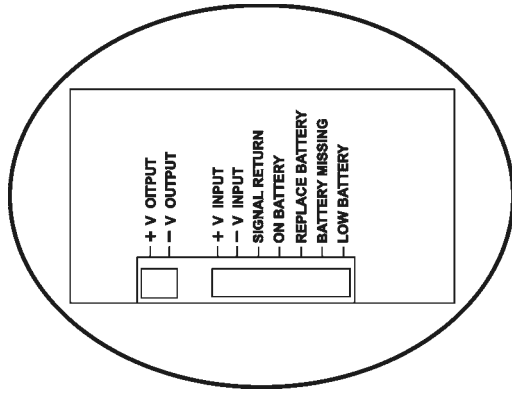

1. Connect the two pin output connector using #16 AWG wire, noting polarity.
2. Connect the five communication signal wires and the two 48 VDC power supply wires to the seven pin IDC, noting polarity. Plug the seven pin IDC into the Battery Back-Up Unit.
3. Connect the Power Supply Unit to utility power. The Battery Back-Up Unit will then start up and the SYSTEM STATUS LED will illuminate.



The Battery Back-Up Unit charges when it is connected to utility power. The battery charges fully during the first eight hours of normal operation. **Do not** expect full battery run capability during this initial charge period.

Operation

Status Indicators

Status indicators are located on the front of the unit.

SYSTEM STATUS	Green indicates the unit is operating normally. Blinking indicates that a fault exists.
BATTERY POWER	Green indicates DC output power is provided by the battery. Blinking indicates a low battery condition.
REPLACE BATTERY	Red indicates that the battery is not connected or the battery needs to be replaced. Refer to the <i>Battery Replacement</i> section.

The auxiliary power connector is located on the side of the unit.

AUXILIARY POWER	Green indicates an Auxiliary DC source is present.
-----------------	--

User Controls

ALARM DISABLE	<ul style="list-style-type: none"> • Press the button once to disable audible alarms for 24 hours. The unit will emit one confirmation beep. • Press the button a second time to enable audible alarms. The unit will emit two confirmation beeps.
BATTERY EMERGENCY USE	Press the button once to allow the use of the reserve battery capacity and/or the auxiliary battery capacity after a low battery shutdown. The unit will emit a confirmation beep.

Battery Replacement

This Battery Back-Up Unit has a user-replaceable battery. Replacement is a safe procedure, isolated from electrical hazards. You may leave the Battery Back-Up Unit and connected equipment on for this procedure.

Replace the spent battery with the RBC64 or an equivalent 12 V 7.2 AHr battery. See your dealer for information on replacement battery modules.

To replace the battery, refer to battery installation instructions found on the unit.



Once the battery is disconnected, the connected equipment is not protected from power outages.



Be sure to recycle the spent battery.

Contact Information

For service and warranty information, contact Verizon FSC at 888-552-7555.

Regulatory Approval

